



# CD-601mkII

Technical Documentation

## PRODUCT OVERVIEW

The TASCAM CD-601mkII is an updated version of the radio-standard CD player. With its comprehensive remote control and flexible monitoring and playback options, the CD-601mkII goes far beyond the capabilities of traditional CD players for broadcast. The operator can select between online play (on the air) and monitor play (pre-listen), controlling whether CD playback reaches the on-air mixer or the monitoring device.



The optional RC-601mkII remote control allows frame-accurate search using the jog wheel, direct location using numerical keys, index searches or flash starts. In addition, the CD-601mkII can store up to 10 cue points per CD; controlled directly using the Flash Start function. Many other features like Pitch Control, Auto Cue with five-threshold levels, Auto Read and CD Text are all designed to reduce stress before the program goes on the air.

**MSRP \$ 2,299.00**

3U half-rack size

Plays CD-DA, CD-RW and CD-R media

Two playback modes:

ON-LINE play: Balanced and AES/EBU outputs enabled  
MONITOR play: Unbalanced and S/PDIF outputs enabled

XLR Balanced and RCA unbalanced outputs

AES/EBU and S/PDIF digital outputs

Fail Safe function to avoid unintentional operation during ON-LINE playback

Instant Start

Single Play, Continuous Play, Program Play (up to 30 tracks)

Incremental Play

Supports CD Text Display

Auto Cue with five threshold levels

Auto Ready

Word Sync In/Thru (44.1kHz or 48kHz)

Sample Rate Converter for 48kHz playback

±12.5% pitch control in 0.1% steps

Power-on Play

Selectable output level (FS = +24, +22, +20 or +15dBu)

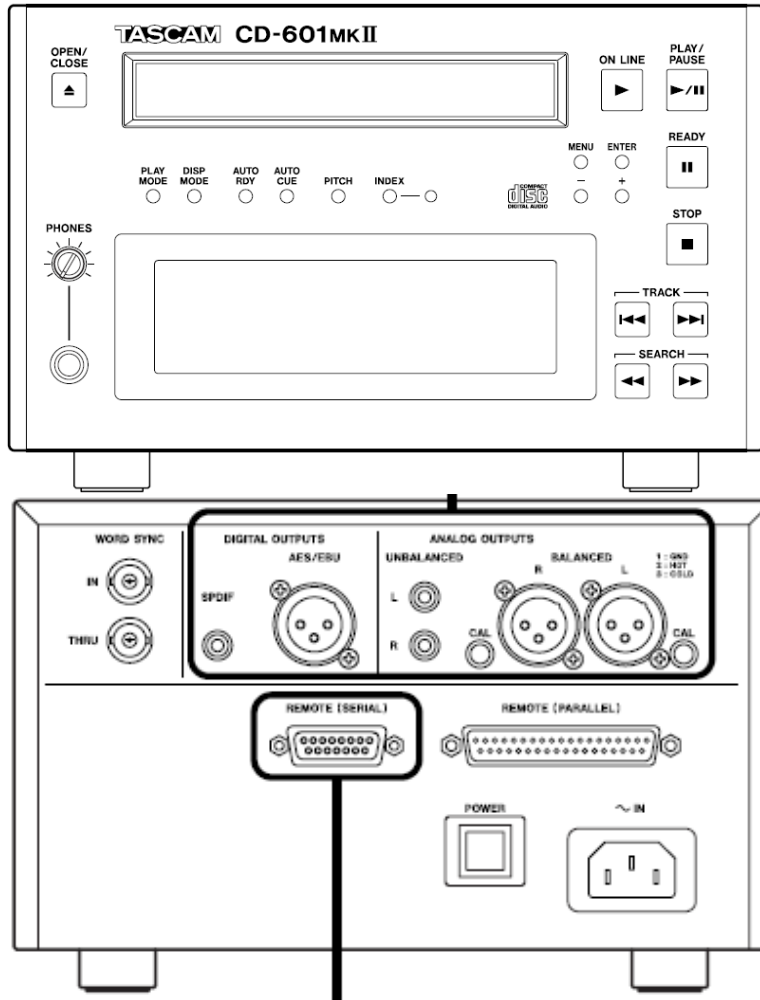

RC-601mkII



CONSULTANT'S AND SYSTEM DESIGN SPECIFICATIONS

The CD-601mkII is a 1/2 rack, 3U rack-mountable professional-use CD player. (Rack-tray sold separately) The CD player features two professional playback modes online playback mode and monitor playback mode for rehearsals. Each of these playback mode signal's can output from different output terminals. The CD-601mkII is equipped with standard features such as Pitch Control (12%+/-), Timer play, Power-on-play, CD text display, Headphone Out w/level control, and single frame accurate cueing. Multiple playback modes include incremental Play, Single Play, Programmed play, Instant Start, and Auto Cue. A Failsafe function is included to prevent inadvertent operation during playback of final take.

The CD-601mkII is equipped with serial (RS-232) and parallel control and word clock in and thru. Analog inputs are via balanced XLR. Digital inputs via unbalanced S/PIDF and AES/EBU via XLR.

## PARALLEL CONTROL INFORMATION

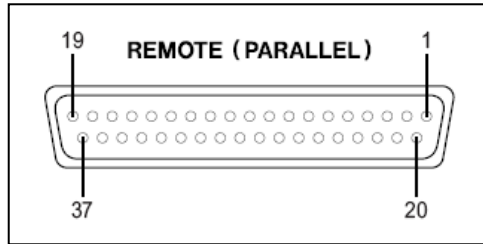

### Pin Arrangement

Pin No.	Signal Name	IN/OUT
1	ON LINE PLAY IN	IN
2	MONITOR PLAY IN	IN
3	PAUSE IN	IN
4	READY IN	IN
5	STOP IN	IN
6	TRACK SEARCH REV IN [  << ]	IN
7	N.C	-
8	TRACK SEARCH FWD IN [ >>  ]	IN
9	SEARCH REV IN [ << ]	IN
10	SEARCH FWD IN [ >> ]	IN
11	MONITOR PLAY TALLY	OUT
12	READY TALLY	OUT
13	PAUSE TALLY	OUT
14	STOP TALLY	OUT
15	INDEX SEARCH REV IN [ <- ]	IN
16	INDEX SEARCH FWD IN [ -> ]	IN
17	ON LINE PLAY TALLY	OUT
18	FLASH READY IN	IN
19	FLASH MODE IN	IN
20	EOM OUT	OUT
21	FADER START/STOP IN	IN
22	ONLINE PLAY / MONITOR PLAY OUT	OUT
23	TEN KEY 0 IN	IN
24	TEN KEY 1 IN	IN
25	TEN KEY 2 IN	IN
26	TEN KEY 3 IN	IN
27	TEN KEY 4 IN	IN
28	TEN KEY 5 IN	IN
29	TEN KEY 6 IN	IN
30	TEN KEY 7 IN	IN
31	TEN KEY 8 IN	IN
32	TEN KEY 9 IN	IN
33	STOP/READY OUT	OUT
34	FLASH READY TALLY	OUT
35	FLASH MODE TALLY	OUT
36	GND	-
37	+5 V	-

### Parallel control I/O specifications

Input : +5 V pull-up, Low Active, 50 ms or more  
 Output : Open collector, 20 mA max.  
 +5 V (pin No. 37) max. current: 100 mA

## SERIAL CONTROL INFORMATION

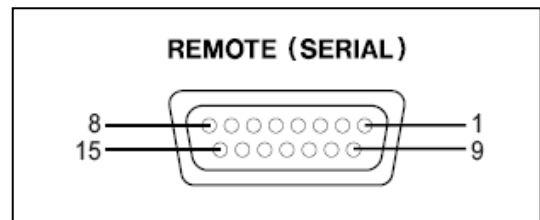

### Pin Arrangement

Pin No.	Signal Name	IN/OUT	
1	SHIELD	-	Shielded (shell ground)
2	RX	IN	Receive data
3	(Reserved)	-	Reserved
4	(Reserved)	-	Reserved
5	(Reserved)	-	Reserved
6	GND	-	Ground
7	(Reserved)	-	Reserved
8	(Reserved)	-	Reserved
9	TX	OUT	Send data
10	(Reserved)	-	Reserved
11	(Reserved)	-	Reserved
12	(Reserved)	-	Reserved
13	(Reserved)	-	Reserved
14	(Reserved)	-	Reserved
15	(Reserved)	-	Reserved

## SPECIFICATIONS

### Rating

Model:	CD player
Discs used:	Compact discs (12 cm, 8 cm)
Compatible discs:	Audio CD (CD-DA), CD-R, CD-RW,
Number of audio channels:	2 channels
Number of quantized bits:	16-bit linear/channel
Sampling frequency:	44.1 kHz
Transmission rate:	4.3218 MB/sec
Modulation method:	EFM
Pickup drive system:	Objective lens drive system, optical type 3 beams
Objective lens drive system:	2D parallel drive system
Light source:	Semiconductor laser
Wavelength:	780 nm

### ANALOG OUTPUTS

#### BALANCED (L, R)

Connector:	XLR 3-31 or equivalent
Specified output level:	+4 dBu
Max. output level:	+24 dBu, +22 dBu, +20 dBu, +15 dBu (according to output level setting)
Output level calibration variable range:	0 dB to -6 dB or more
Output impedance:	150 $\Omega$

#### UNBALANCED (L, R)

Connector:	RCA
Specified output level:	-10 dBV
Max. output level:	+6 dBV
Output impedance:	100 $\Omega$

#### PHONES

Connector:	Stereo phone jack
Max. output level:	50 mW + 50 mW (at 32 $\Omega$ load)

### DIGITAL OUTPUTS

#### AES/EBU

Connector:	XLR 3-31 or equivalent
Output signal format:	IEC60958-4 (AES/EBU)
Output impedance:	110 $\Omega$
Sampling frequency:	44.1 kHz, 48 kHz (at word synchronization)

#### SPDIF

Connector:	RCA pin jack
Output signal format:	IEC60958-3 (S/PDIF)
Output impedance:	75 $\Omega$
Sampling frequency:	44.1 kHz, 48 kHz (at word synchronization)

### Other I/O

#### WORD SYNC IN

Connector:	BNC
Input impedance:	75 $\Omega$ (automatic termination)
Input level:	TTL level
Synchronizing frequency range:	44.1 kHz $\pm$ 0.1% and 48 kHz $\pm$ 0.1%

#### WORD SYNC THRU

Connector:	BNC
------------	-----

#### REMOTE (PARALLEL)

Connector:	37-pin D-Sub female
------------	---------------------

#### REMOTE (SERIAL)

Connector:	15-pin D-Sub female
Electrical characteristics:	RS-232C-compliant

### Analog Output Electrical Characteristics

The following characteristics are the balanced and unbalanced analog output specifications.

Playback frequency response:	20 Hz to 20 kHz, $\pm$ 0.5 dB
Signal-to-noise ratio:	102 dB or more (20 kHz LPF, A-weighted)
Dynamic range:	98 dB or more (20 kHz LPF, A-weighted) [1 kHz max. output level -60 dB]
Distortion (THD+N):	0.008% or less (20 kHz LPF) [1 kHz max. output level]
Channel Separation:	90 dB or more [1 kHz]
Wow flutter:	Measured limit value or less

### Other Characteristics

Audio rise time:	Within 10 msec
Anti-shock time:	20 seconds

### General

Power requirements:	
USA/CND:	120 V AC, 60 Hz
EUR/UK:	230 V AC, 50 Hz
AUS:	240 V AC, 50 Hz
Power consumption:	24 W
External dimensions:	220 W x 142 H x 382.4 D (mm) (including feet and protrusions)
Weight:	6.0 kg
Operating temperature:	5 to 35°C
Max. tilt of installation surface:	5 degrees
Accessories:	Power cable, Owner's Manual, Warranty

- Specifications and external appearance are subject to change without notice in the interest of product improvement.
- Note that illustrations in the Owner's Manual may differ on some products due to product improvements.

### External Dimensions

